

Norwegian

Mobi bilsete for barn, godkjent for barn fra 9-25 kilo installert med ryggen mot kjøretretningen, i for- og baksetet, i henhold til regulativ ECE44 rev 03.

- Passer i de fleste biler
- Enkelt å installere takket være de unike bilbelteforankringene
- Utstyrt med fempunktsseler, med høydejustering for tre stillinger
- Enhånds justering
- Mobi har fire hvile/liggestillinger, kan reguleres etter installasjon i bilen
- Godkjent med støtteben
- Unike holdere sikrer at selene ikke er i veien og gjør det enklere å få barnet inn og ut av setet
- Avtakbart trekk, kan vaskes for hånd
- Solskjerm og koppholdere finnes som tilleggsutstyr
- Fire fargevalg
- Nytt lavt innfestningssystem for stabil installasjon

Finnish

Mobi-turvastuin, tarkoitettu asennettavaksi autojen etu- ja takaistuimille selkä menosuuntaan 9-25 kilon painoisille lapsille, on normin ECE44/03 mukainen.

- Sopii useimpiin autoihin
- Helppo asentaa ainutlaatuisten turvavyökiinnittimien ansiosta
- Varusteena viisipisteturvavyö, jonka korkeus voidaan säätää kolmeen eri asentoon
- Säätö yhdellä kädellä
- Mobin selkänöja voidaan säätää neljään eri asentoon, kun se on asennettu autoon
- Hyväksytty käytettäväksi tukiraudan kanssa, voidaan käyttää pikkubusseissa
- Ainutlaatuiset pidikkeet pitävät turvavyön pois tieltä helpottaen lapsen irrottamista turvaistuimesta ja asettamista siihen
- Irrotettava, pestävä päälinen
- Lisävarusteina aurinkokuomu ja kuppelineet
- Neljä eri väriä
- Uusi kiinnityshihnajärjestelmä tukevan kiinnityksen varmistamiseksi

Mobi

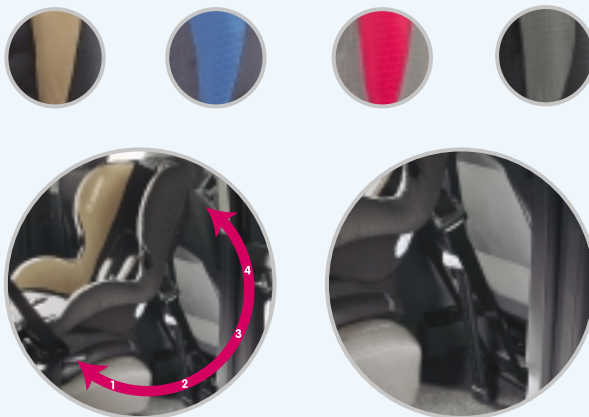

English

Mobi child restraint, approved rearward facing for children 9-25 kilos in front and rear seats, in accordance with regulation ECE44 rev 03.

- Fits most vehicles
- Simple to install thanks to the unique seat belt anchors
- Equipped with five-point harness, height adjustable for three positions
- One hand adjustment
- Mobi has four recline positions, adjustable when installed in the vehicle
- Approved with floor support, can be used in mini-vans
- Unique holders keep harness out of the way, eases exit and entry for the child
- Removable, washable cover
- Sunshade and cup-holders available accessories
- Four colour choices
- New low tether system for firm installation

Swedish

Mobi bilbarnstol, godkänt för barn (9-25 kg) som åker bakåtvända i fram- och baksäte, enligt direktivet ECE 44 rev 03.

- Passar de flesta fordon
- Enkel att installera tack vare de unika bilbältesförankringarna
- Utrustad med fempunktssela, som kan justeras i tre olika höjdlägen
- Enhandsjustering av interna bältet
- Mobi har fyra vilolägen, som kan justeras när det installerats i fordonet
- Godkänt med golvstöd, kan användas i minivans
- Unika hållare håller interna bältet ur vägen, förenklar fästsättning och urstigning för barnet
- Avtagbar klädsel som går att tvätta för hand
- Solskydd och mugghållare är tillgängliga tillbehör
- Fyra färgval
- Nytt lågt fjättringssystem för säker montering

The safe world of Maxi-Cosi





Car list Maxi-Cosi Mobi

The Maxi-Cosi Mobi is classified for "Restricted/Semi-universal" use and is suitable for fixing into seat positions of the following cars:

CAR (and model):

	FRONT SEAT A yes	Outer B yes	REAR SEAT Centre C yes
Alfa Romeo: 33, 75, 146, 147, 155, 156, 164, 166	✓	✓	✓
Audi: Allroad, 80, 90, 100, A2, A3, A4, A6, A8	✓	✓	✓
BMW: 3, 5, 6, 7, 8 series	✓	✓	✓
Chevrolet: Alero, Astro, Caprice, Corsica, Suburban, Tahoe, TransSport	✓	✓	✓
Chrysler: 300M, Neon, PT Cruiser, Stratus, Voyager	✓	✓	✓
Citroen: AX, BX, CX, DS, C5, ZX, XM, Berlingo, Evasion, Saxo, Xsara, Xantia	✓	✓	✓
Daewoo: Evanda, Kalos, Lacetti, Lanos, Leganza, Matiz, Nubira, Tacuma	✓	✓	✓
Daihatsu: Charade, Rocky, Siron, YRV	✓	✓	✓
Daimler: Sovereign	✓	✓	✓
Fiat: Argenta, Brava, Bravo, Croma, Marea, Panda, Punto, Regata, Stilo, Tempra, Tipo, Uno	✓	✓	✓
Ford: Aerostar, C-Max, Cougar, Fiesta, Escort, Explorer, Focus, Granada, Galaxy, Ka, Mondeo, Mustang, Probe, Puma, Orion, Scorpio, Sierra, Windstar	✓	✓	✓
Honda: Accord, Civic, CR-V, HR-V, Jazz, Legend, Logo, Prelude, Shuttle	✓	✓	✓
Hyundai: Accent, Atos, Elantra, Getz, Matrix, Pony, Santa Fe, S-Coupe, Sonata, Terracan, Trajet, XG	✓	✓	✓
Isuzu: Gemini, Trooper	✓	✓	✓
Jaguar: Sovereign, S-type, X-type, XJ, XK	✓	✓	✓
Jeep: Cherokee, Grand Cherokee, Wrangler	✓	✓	✓
Kia: Carens, Carnival, Magentis, Pride, Rio, Shuma, Sorento	✓	✓	✓
Lada: Niva, Samara	✓	✓	✓
Lancia: Dedra, Delta, Gamma, Kappa, Lybra, Musa, Thema, Thesis, Ypsilon	✓	✓	✓
Landrover: Defender, Discovery, Freelander, Range Rover	✓	✓	✓
Lexus: GS, IS, LS, RX, SC	✓	✓	✓
Mazda: 3, 6, 121, 323, 626, 929, Demio, MPV, Premacy, Xedos	✓	✓	✓
Mercedes: A, C, CL, ML, E, G, S-class	✓	✓	✓
Mini: new Mini	✓	✓	✓
Mitsubishi: Carisma, Colt, Galant, Lancer, Outlander, Pajero, Sigma, Space Runner, Space Wagon	✓	✓	✓
Nissan: Almera, Bluebird, King Cab, Micra, Primera, Sunny, Terrano	✓	✓	✓
Opel: Agila, Ascona, Astra, Calibra, Corsa, Frontera, Kadett, Omega, Vectra, Zafira	✓	✓	✓
Peugeot: 104, 106, 204, 205, 206, 305, 306, 307, 309, 405, 406, 505, 507, 607, 806, Partner	✓	✓	✓
Renault: 16, 18, 19, 21, Clio, Espace, Kangoo, Laguna, Mégane, Safrane, Scenic, Twingo	✓	✓	✓
Rover: 200, 416, 420, 620, R75	✓	✓	✓
Saab: 90, 93, 95, 99, 900, 9000, 9-3, 9-5	✓	✓	✓
Seat: Alhambra, Cordoba, Ibiza, Inca, Leon, Stella, Toledo, Cordoba Vario	✓	✓	✓
Skoda: Fabia, Favorit, Felicia, Octavia, Superb	✓	✓	✓
Subaru: Forester, Impreza, Legacy, Outback	✓	✓	✓
Suzuki: Alto, Baleno, Grand Vitara, Jimny, Sprint, Swift, Vitara	✓	✓	✓
Toyota: Avensis, Verso, Camry, Carina, Celica, Corolla, Corolla Verso, Land Cruiser, Previa, RAV-4, Tercel, Yaris, Yaris Verso	✓	✓	✓
Volkswagen: 1500, Bora, Caddy, Caravelle, Corrado, Golf, Jetta, Lupo, New Beetle, Passat, Polo, Santana, Sharan, Vento	✓	✓	✓
Volvo: S40, V40, S50, V50, C70, S70, V70, S80, S90, V90, 240-265, 340-360, 440-480, 740-780, 850, 940-960, XC	✓	✓	✓

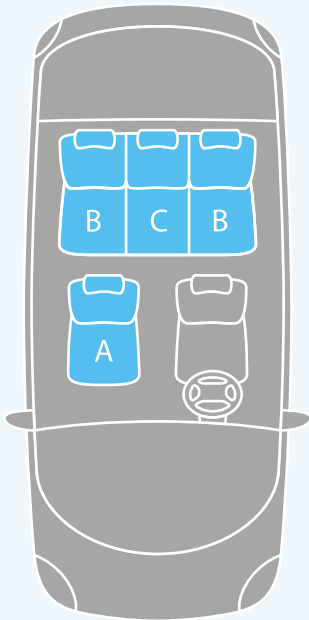

Seat positions in other cars may also be suitable to accept this child-restraint. If in doubt, consult either the child restraint manufacturer or the retailer.

A Some vehicles in these model series have passenger air bags. Never use the Mobi in passenger seats which have functional frontal passenger airbags

C Some vehicles in these model series have rear consoles in the middle. In some, but not all, the console may prohibit correct use of the floor support. Use Mobi only if the floor support can be used in the drawings marked OK below

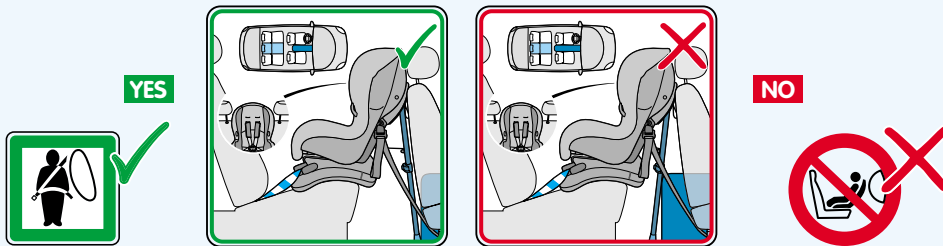

The safe world of Maxi-Cosi

